

INTERIOR FINISH SCHEDULE (CONTINUED FROM SHEET A9)

Plan Ref. Symbol: FRP10 (Fiber Reinforced Panel) Manufacturer: Marfilite Pattern Name & #: Standard FRP Color Name & #: To be determined Remarks: Rising Sun Kitchen #131 from base to ceiling, & to 4' high in Utility rooms where indicated.	Plan Ref. Symbol: PL16 (Plastic Laminate) Manufacturer: Wilsonart Pattern Name & #: Standard P-Lam Color Name & #: To be determined Remarks: Countertops in BMAC spaces.
Plan Ref. Symbol: PL10 (Plastic Laminate) Manufacturer: Wilsonart Pattern Name & #: Standard P-Lam Color Name & #: To be determined Remarks: All upper and lower cabinets	Plan Ref. Symbol: ACP10 (Acoustic Ceiling Panel) Manufacturer: Armstrong Pattern Name & #: Cortega Second Look, 2' x 4' Color Name & #: White Remarks: Throughout remodel areas. Install in Prelude 15/16" standard "T" 2' x 4' grid.
Plan Ref. Symbol: PL11 (Plastic Laminate) Manufacturer: Wilsonart Pattern Name & #: Standard P-Lam Color Name & #: To be determined Remarks: Countertops & Toilet Room wainscots (to 4' high) in Common spaces where shown.	Plan Ref. Symbol: BL10 (Window Blinds) Manufacturer: Levolor Pattern Name & #: Riviera Dustguard 1" blind Color Name & #: To be determined Remarks: 1" horizontal vanes
Plan Ref. Symbol: PL12 (Plastic Laminate) Manufacturer: Wilsonart Pattern Name & #: Standard P-Lam Color Name & #: To be determined Remarks: Countertops in WW County spaces.	
Plan Ref. Symbol: PL13 (Plastic Laminate) Manufacturer: Wilsonart Pattern Name & #: Standard P-Lam Color Name & #: To be determined Remarks: Countertops in Helpline spaces.	
Plan Ref. Symbol: PL14 (Plastic Laminate) Manufacturer: Wilsonart Pattern Name & #: Standard P-Lam Color Name & #: To be determined Remarks: Countertops & Toilet Room wainscot (to 4' high) in Heart To Heart spaces where shown.	
Plan Ref. Symbol: PL15 (Plastic Laminate) Manufacturer: Wilsonart Pattern Name & #: Standard P-Lam Color Name & #: To be determined Remarks: Countertops & Toilet Room wainscot (to 4' high) in Rising Sun spaces where shown.	

INTERIOR FINISH LEGEND & NOTES

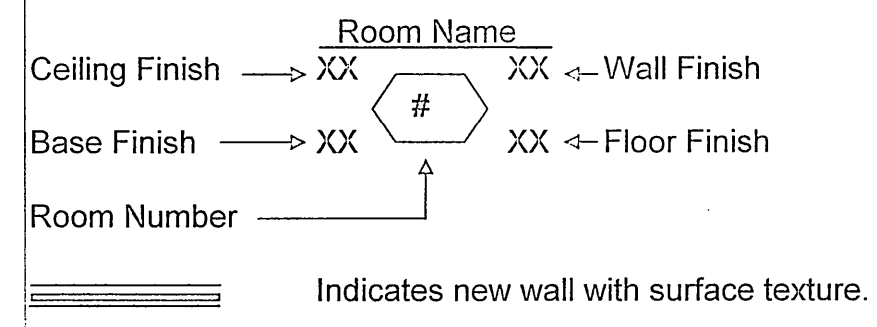

Interior Finish Notes

1. See floor plans for dimensions. Do not scale the drawings.
2. See the Interior Finish Schedule for finish materials as noted on the plans.
3. New interior gypsum wallboard to be taped, textured "light orange peel", sealed and painted (two coats). Contractor shall submit an 8-1/2" x 11" sample of the texture to the Architect for approval prior to application.
4. Existing partitions are to be painted (one coat) where indicated on the plans.
5. All new wood door trim is to be finished (stained & varnished) to match existing.
6. All new wood base is to be painted to match wall color.
7. "E" indicates existing finishes to remain.

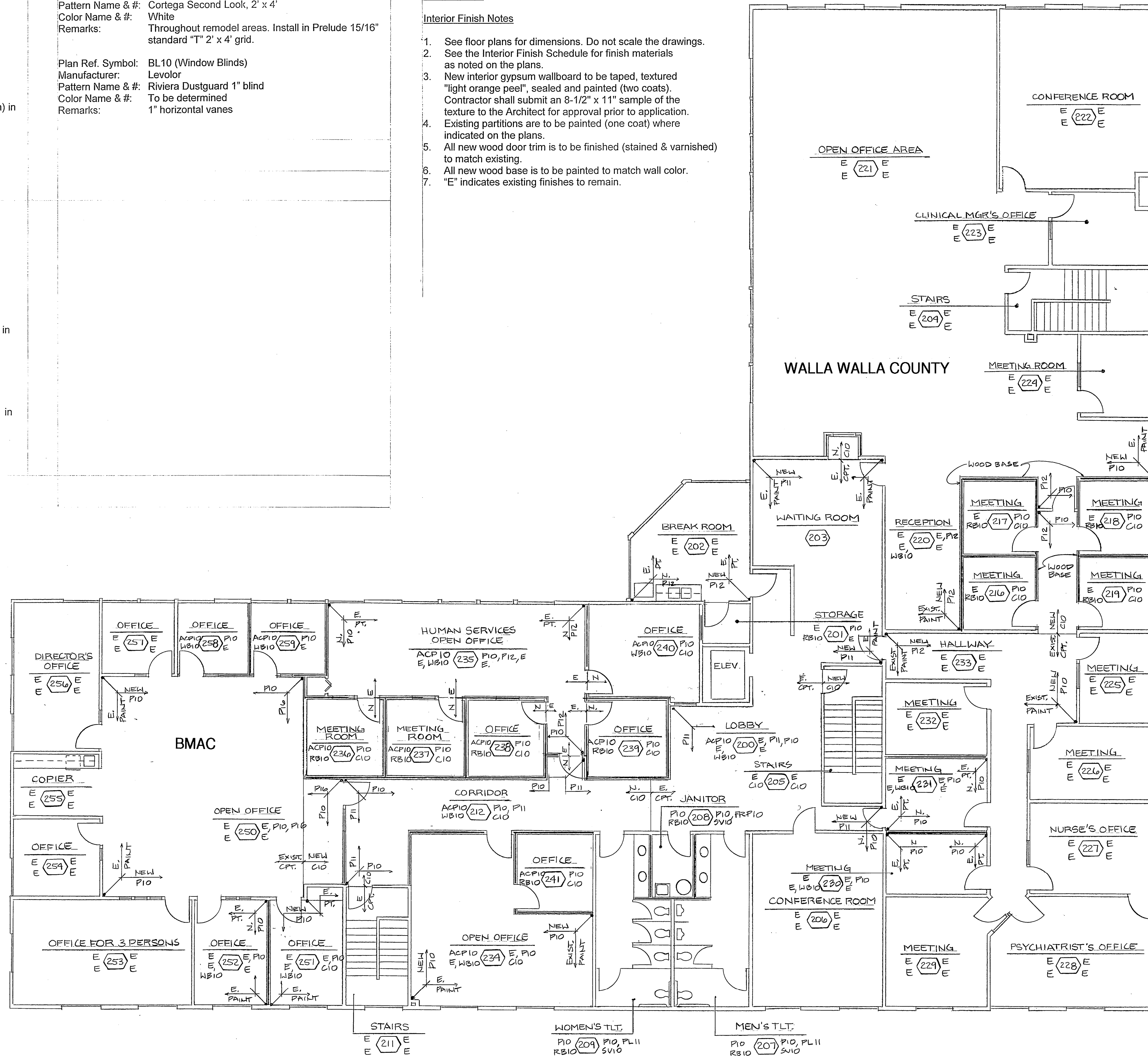

Stenkamp Architecture
 315 Spokane Street
 Richland, Washington 99354
 (509) 371-8086

Community Services Center Remodel
 For
Walla Walla County
 Walla Walla, Washington

**SECOND FLOOR
 INTERIOR FINISH PLAN**

PROJECT #1185
A10